

**NOTES**

- THIS DRAWING IS TO BE READ IN CONJUNCTION WITH ALL ENGINEERS & ARCHITECTS DRAWINGS FIGURED DIMENSIONS ONLY (NOT SCALING) TO BE USED. WHERE A CONFLICT OF INFORMATION EXISTS OR IF IN ANY DOUBT - ASK.
- CONSULTANTS TO BE INFORMED IMMEDIATELY OF ANY DISCREPANCIES BEFORE WORK PROCEEDS.

STEEL MEMBERS SCHEDULE			
FOUNDATION SCHEDULE			
REF.	SIZE	REF.	SIZE
PF1	1000 x 1000 Dp. RC. PAD FOUNDATION	PF2	1750 x 1750 Dp. RC. PAD FOUNDATION
PF3	2000 x 2000 Dp. RC. PAD FOUNDATION	PF4	3000 x 3000 Dp. RC. PAD FOUNDATION
PF5	4000 x 1200 Dp. RC. PAD FOUNDATION	PF6	5000 x 5000 Dp. RC. PAD FOUNDATION
SF1	900 x 300 Dp. RC. STRIP FOOTING		

CONCRETE COLUMN SCHEDULE			
REF.	SIZE	REF.	SIZE
C1	800 x 200 RC. COLUMN		

**SITE BOUNDARY**

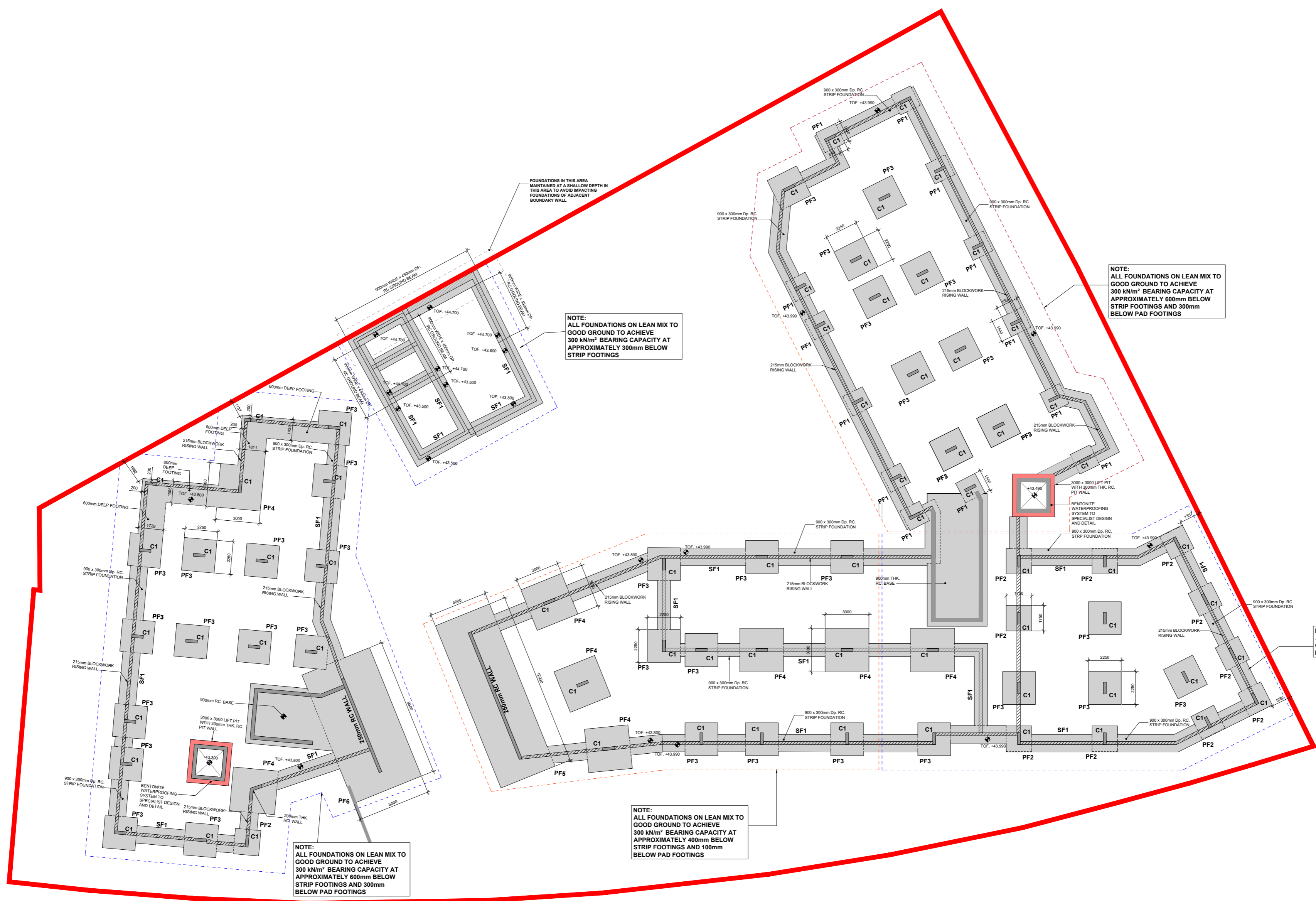

**FOUNDATION PLAN**  
SCALE @ A3: 1:500  
SCALE @ A2: 1:200

PL1	11.03.22	ISSUED FOR PLANNING	JN
ISSUE	DATE	DESCRIPTION	BY
Project Engineer: RMAA		Project Director: BM	
BM STAGE			
<b>PLANNING</b>			
DUBLIN OFFICE: 50-54 Lower Selsketh Street, Dublin 2, Ireland. Tel: 01 47 2200 Fax: 01 477 3164 LONDON OFFICE: 5th Floor, 481-485, & 5th Street, London EC2A 4PU, United Kingdom. Tel: (0044) 20 3750 3030 Consulting Engineers, Civil, Structural, Project Management E-mail: bmc@bmc.ie Web: www.bmc.ie			
CLIENT: ORCHID RESIDENTIAL LTD.			
PROJECT TITLE: GOATSTOWN STUDENT ACCOMMODATION		BM PROJECT No: 19.289	
REFERENCE	SUBMITALITY	REVISION	
DRAWING TITLE: FOUNDATION LAYOUT			
DRAWING REFERENCE: 19289-BMD-ZZ-FN-DR-S-2000	STATUS	REVISION	
		PL1	